

S3(5) Notice and S3(6) Deposit of
Map or statement.

CA16/1

ECONOMY AND ENVIRONMENT	
18 FEB 2013	
NAME	
POST	
ADDRESS	

697 Halifax Road
Cleckheaton
West Yorks
England
GB-BD19 6LJ

+44

Calderdale M.B.C.
Planning and Environmental Dep't
Halifax

12 February 2013

Dear Sirs.

RE: Renewal of 6-year notice of lands not open to the public, enclosed docu

The enclosed land situated within Calderdale MBC at aprox Se122222 is NOT open to the public and is private; encompassing the registered land known as Far Bin having been so been since this notice was originally issued in 1988. This notice issued under the Act as signs are regularly defaced and / or removed. The land concerned is bordered in Red and is not within an area covered by the Freedom Access Act.

EXEPTING for those rights of the public over private land designated Blue and defined as rights of ways 140 [Bridleway not open to all traffic] & 110 (part) [footpath only] plus 2m small section of unknown number diverging towards la Messrs W T Knowles & Co Ltd; all of which are not exceeding nominal 1.2m in width.

D J & V M Long

L:/ Far Bins/ Access notice CMBC
Diary 12.02.18

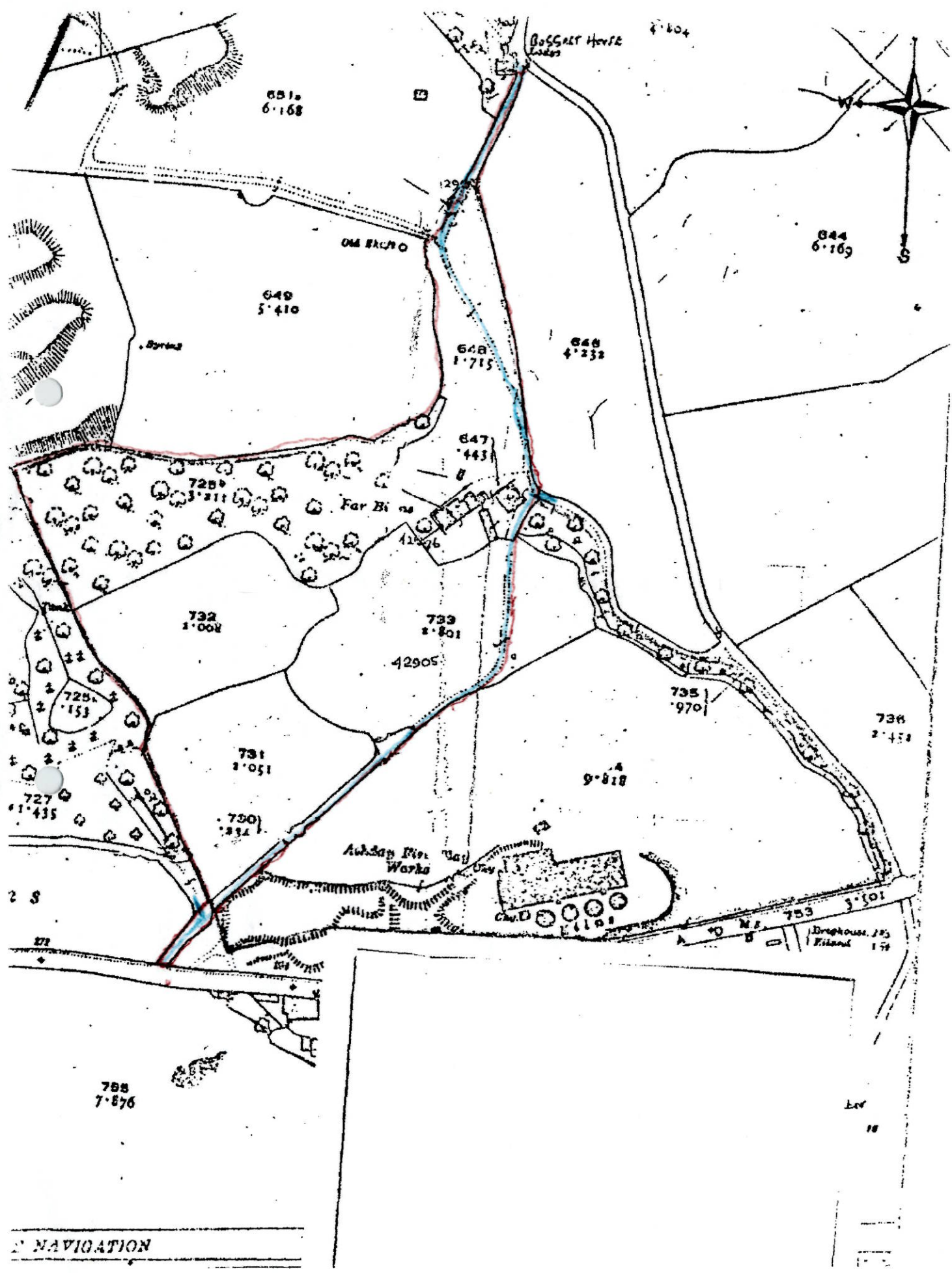

NAVIGATION