

CA16/7/8/1

Rachel Finney
Calderdale Council
Rights of Way Team
Regeneration & Development
Engineering Services
Northgate House
Halifax
HX1 1UN

Stephenson House
Burlees Lane
Wadsworth
Hebden Bridge
West Yorkshire
HX7 8PS

26th February 2008

20 FEB 2008

Dear Rachel,

Ref:-Birchen Lee Carr, Raw Lane, Mytholmroyd, HX7 5RF

Further to our brief meeting yesterday regarding footpaths / bridleways adjacent to Birchen Lee Carr, enclosed please find three maps that clearly show the existing footpaths 032 & 042 on the northern & western boundaries respectively for Birchen Lee Carr.

As per the Highways Act of 1980 Section 31 - Clause 6 I hereby declare by Statutory Declaration that "as the owner, or by any of my successors in title lodged by me or them to Calderdale Council to the effect that no additional way (other than any specifically indicated in the declaration as shown in Maps 1-3 attached to this declaration) over the land delineated on the said map has been dedicated as a highway since the date of deposit, or since the date of lodgment of such previous declaration, as the case may be, are, in the absence of proof of a contrary intention".

Trust this is in order and I would be grateful if you could confirm receipt of same and send such to my Stephenson House address detailed above.

Rachel, thanks for your assistance in this matter.

yours sincerely,

Ian Lindsay

PLAN 1

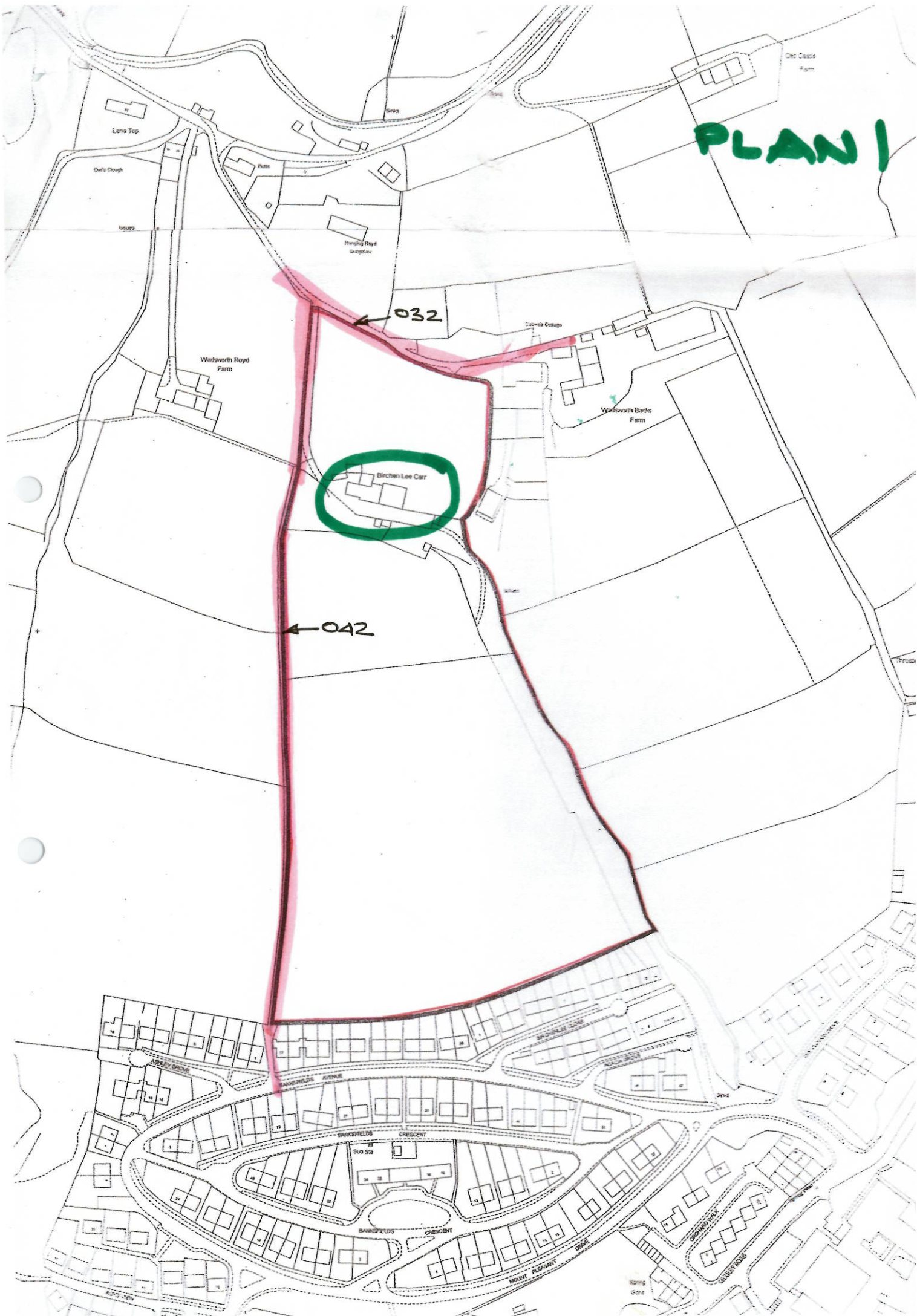

N
2
4
0

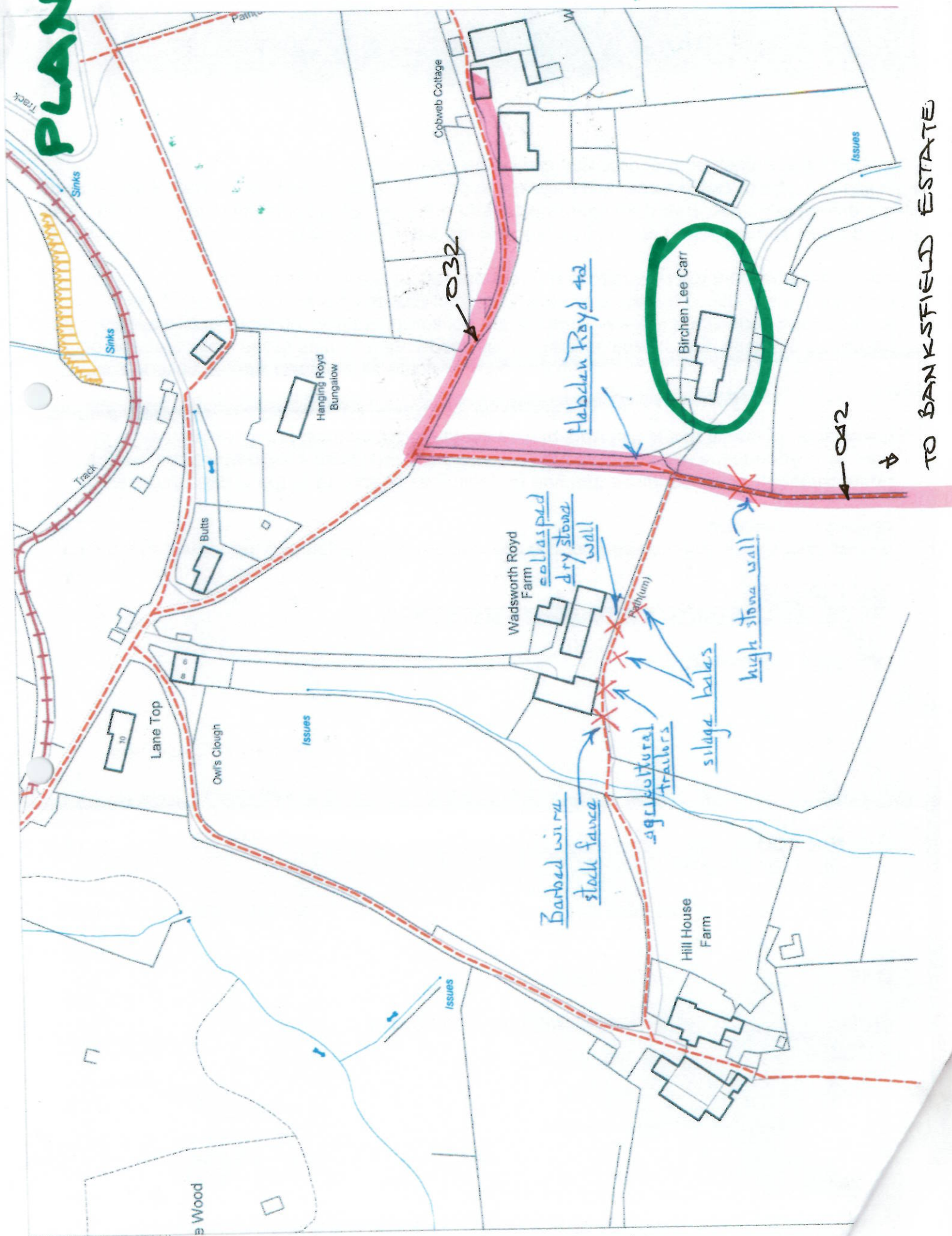

PLAN 3

