

3.15.1/15J

FORM WCAS

**CALDERDALE METROPOLITAN BOROUGH COUNCIL**

**WILDLIFE AND COUNTRYSIDE ACT 1981**

**The Wildlife and Countryside**  
**(Definitive Maps and Statements)**  
**Regulations 1993 Schedule 7)**

**DEFINITIVE MAP AND STATEMENT FOR CALDERDALE**

**DISTRICT OF:** METROPOLITAN BOROUGH OF CALDERDALE

**PARISH OF:** TODMORDEN

**TO:** CALDERDALE METROPOLITAN BOROUGH COUNCIL

**OF:** NORTHGATE HOUSE, NORTHGATE, HALIFAX, HX1 1UN

**By:** (name of applicant) MR J. D. MITCHELL

**At:** (address of applicant) LOWER KILNHURST HOUSE  
TODMORDEN  
LANCS

OLIA GAX

hereby apply for an order under Section 53(2) of the Wildlife and Countryside Act 1981 modifying the Definitive Map and Statement of the Area by:

1. Deleting the \*(footpath) (bridleway) (by-way open to all traffic)

shown as number DEFINITIVE = FOOTPATH TODMORDEN No 160

from POINT 'A' } REFER SHEET No 5 - COPY OF  
to POINT 'B' } SEALING BOOK REFERENCE 22718A

2. Adding the \*(footpath) (bridleway) (by-way open to all traffic)

from N/A

to

3. \*(Upgrading) (downgrading) to a \*(footpath) (bridleway) (by-way open to all traffic) the \*(footpath) (bridleway) (by-way open to all traffic)

shown as number

from

N/A

to

SHEET 1

4. \*(Varying) (adding to) the particulars relating to the \*(footpath) (bridleway) (by-way open to all traffic)  
shown as number  
from  
to N/A  
by providing that  
and shown on the map accompanying this application

I/We attach a map and copies of the following documentary evidence (including statements of witnesses) in support of this application:-

List of Documents provided:

REFER TO SHEET 6 HERewith

Dated: 22/4/04

Signed: [REDACTED]

\* Please delete as appropriate

ALIBAHWAYS CCS 149 RIGHTWAY ENI (R)

SHEET 2

FORM OF NOTICE OF APPLICATION FOR MODIFICATION ORDERSection 53(5) of, and Schedule 14 to, the Wildlife and Countryside Act 1981Definitive Map and Statement for Calderdale

To: MR & MRS D. NEWTON  
 LOWER KILNHURST FARM  
 Of: TODMORDEN  
 LANC'S  
 OLIA GAX  
 I/We MR J. O. MITCHELL  
 LOWER KILNHURST HOUSE  
 of: TODMORDEN  
 LANC'S  
 OLIA GAX

hereby give notice on 17<sup>th</sup> APRIL 2004 19 I/We made application to the  
 Calderdale MBC that the definitive map and statement for the area be

1. modified by [deleting the [footpath] [bridleway] [by-way open to all  
 traffic] from POINT 'A' TO POINT 'B' ON DEFINITIVE FOOTPATH  
 TODMORDEN NO 160 to AS SHOWN ON SHEET 5 - COPY  
 OF SEALING BOOK REF 227184
2. ~~[adding the [footpath] [bridleway] [by-way open to all traffic] from~~  
~~to~~ 1
3. ~~[[upgrading] [downgrading] to a [footpath] [bridleway] [by-way open to all  
 traffic] the [footpath] [bridleway] [by-way open to all traffic] from~~  
~~to~~ 1
4. ~~[[varying] [adding to] the particulars relating to the [footpath]  
 [bridleway] [by-way open to all traffic]] from~~  
~~to~~ by  
 providing that 1.

Dated

22/4

15 2004

Signed

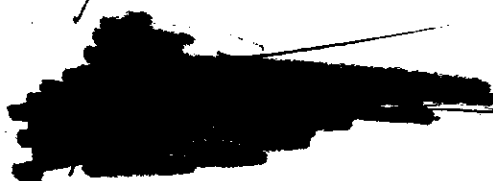

CERTIFICATE OF SERVICE OF NOTICE OF APPLICATION FOR A MODIFICATION ORDER

WILDLIFE AND COUNTRYSIDE ACT 1981

The Wildlife and Countryside  
(Definitive Maps and Statements)  
Regulations 1983

DEFINITIVE MAP AND STATEMENT  
DISTRICT OF  
PARISH OF

TO: CALDERDALE METROPOLITAN BOROUGH COUNCIL

OF: NORTHGATE HOUSE, NORTHGATE, HALIFAX, HEX1 1UN

I/We (name of applicant) MR J. O. MITCHELL

Of (address of applicant) LOWER KILNHURST HOUSE  
TODMORDEN

LANCS OL14 6AX

I hereby certify that the requirements of paragraph 2 of Schedule 14 to the  
Wildlife and Countryside Act 1981 have been complied with. (Paragraph 2 is  
printed on the reverse of this form).

Details of Modification DELETION OF FOOTPATH SHOWN BETWEEN  
POINT 'A' AND POINT 'B' ON DEFINITIVE FOOTPATH  
TODMORDEN NO 160 AS SHOWN ON SHEET 5 - COPY  
OF SEALING BOOK REFERENCE 227184

List of Owners and Occupiers Notified

PLOT NO	OWNER/OCCUPIER	ADDRESS	DATE NOTICE SERVED
	MR & MRS D NENTON	LOWER KILNHURST FARM TODMORDEN	12/03/2004
		LANCS	
		OL14 6AX	

Signed

Date 22/4/04

RIGHTWAYBJG, S/EN1/GR

SHEET A

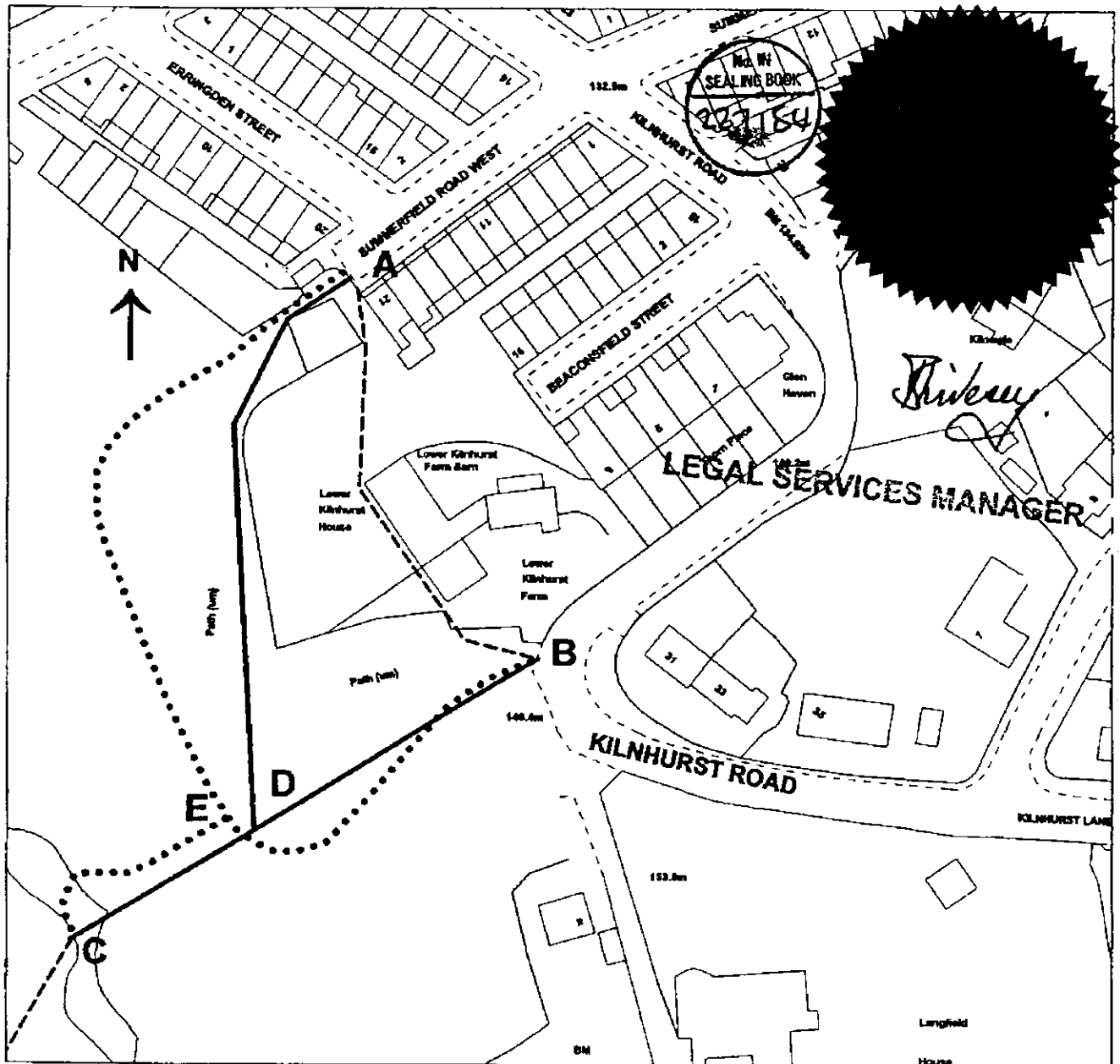

# METROPOLITAN BOROUGH OF CALDERDALE

Proposed diversion  
Definitive footpath Todmorden no. 160  
Kilnhurst, Todmorden

Scale 1:1000

ENGINEERING SERVICES  
NORTHGATE HOUSE, NORTHGATE, HALIFAX  
HX1 1UN

## KEY

- Path to be closed
- ..... Replacement path
- Other public footpaths
- + + + + + Other public bridleways

"This copy has been made by or with the authority of Calderdale MBC pursuant to section 47 of the Copyright, Designs and Patents Act 1988 ("the Act"). Unless the Act provides a relevant exception to copyright, the copy must not be copied without the prior permission of the copyright owner."

*SHEET 5,*